

Inserts for two-piece fittings – US End Configurations

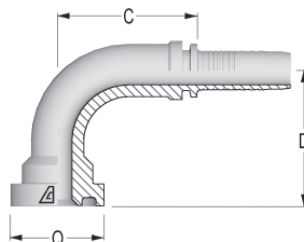

For Code 62 Split Flange Clamps, please refer to page 198.

90° O-Ring Flange SAE J518 Code 62

Part Number	Dash Size	Hose ID Size		Q Flange		C Cut-Off Factor (mm)	D Drop (mm)	Max. Working Pressure (psi)	Weight (lbs/each)
		(in)	(mm)	(in)	(mm)				
A-0808-C629	08	1/2	12.7	1.25	31.8	47.8	46	6000	0.33
A-0812-C629	08	1/2	12.7	1.63	41.3	47.8	54	6000	0.88
A-1212-C629	12	3/4	19.0	1.63	41.3	63.2	61	6000	0.62
A-1216-C629	12	3/4	19.0	1.88	47.6	63.2	66	6000	0.93
A-1616-C629	16	1	25.4	1.88	47.6	73.6	75	6000	1.05
A-1620-C629	16	1	25.4	2.13	54.0	77.6	78	6000	1.32
A-2020-C629	20	1 1/4	31.8	2.13	54.0	94.5	89	6000	1.59
A-2024-C629	20	1 1/4	31.8	2.50	63.5	98.0	94	6000	2.09
A-2424-C629	24	1 1/2	38.1	2.50	63.5	99.6	105	6000	2.57
A-2432-C629	24	1 1/2	38.1	3.13	79.4	114.7	123	6000	2.21
A-3232-C629	32	2	50.8	3.13	79.4	143.3	132	6000	2.32

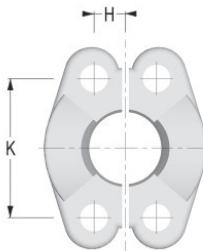

Split Flange Clamps SAE J518 Code 61 – 3000 PSI (2 Halves/Pieces per 1 Part)

Part Number	Flange Size (in)	H (mm)	K (mm)	Max. Working Pressure (psi)	Weight (lbs/each)
C61SF-08	1/2	8.7	38.1	3000	0.22
C61SF-12	3/4	11.1	47.6	3000	0.38
C61SF-16	1	13.1	52.4	3000	0.50
C61SF-20	1 1/4	15.1	58.7	3000	0.67
C61SF-24	1 1/2	17.9	69.9	3000	1.01
C61SF-32	2	21.4	77.8	3000	1.18
C61SF-40	2 1/2	25.5	89.0	2500	1.89

Note: Bolts, washers and o-ring are not included.

Because we continually examine ways to improve our products, we reserve the right to alter specifications or discontinue products without prior notice.