

A Series Non-Skive Ferrules

AF1

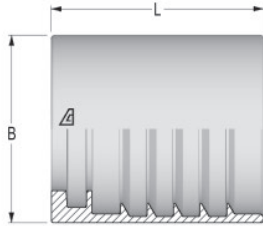

Part Number	Dash Size	Hose ID Size		B OD (mm)	L Length (mm)	Weight (lbs/each)
		(in)	(mm)			
AF1-03	03	3/16	4.8	19.0	24.0	0.05
AF1-04	04	1/4	6.4	22	24.7	0.06
AF1-05	05	5/16	7.9	23	24.7	0.07
AF1-06	06	3/8	9.5	26	29.7	0.10
AF1-08	08	1/2	12.7	29	30.5	0.11
AF1-10	10	5/8	15.9	32	30.5	0.12
AF1-12	12	3/4	19.0	36	36.0	0.17
AF1-16	16	1	25.4	44	36.7	0.24
AF1-20	20	1 1/4	31.8	53	48.6	0.40
AF1-24	24	1 1/2	38.1	61	48.6	0.50
AF1-32	32	2	50.8	75	48.6	0.70

NOTE: Also available in stainless steel in some sizes. To order stainless, add -SS to the end of the part number. Example: A-0606-XXXX-SS

AF2

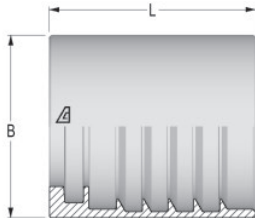

Part Number	Dash Size	Hose ID Size		B OD (mm)	L Length (mm)	Weight (lbs/each)
		(in)	(mm)			
AF2-03	03	3/16	4.8	21	24.0	0.06
AF2-04	04	1/4	6.4	23	24.7	0.07
AF2-05	05	5/16	7.9	25	24.7	0.08
AF2-06	06	3/8	9.5	27	29.7	0.10
AF2-08	08	1/2	12.7	30	30.5	0.12
AF2-10	10	5/8	15.9	33	30.5	0.13
AF2-12	12	3/4	19.0	37	36.0	0.18
AF2-16	16	1	25.4	45	36.7	0.24
AF2-20	20	1 1/4	31.8	56	48.6	0.45
AF2-24	24	1 1/2	38.1	64	48.5	0.55
AF2-32	32	2	50.8	76	48.6	0.70

NOTE: Also available in stainless steel in some sizes. To order stainless, add -SS to the end of the part number. Example: A-0606-XXXX-SS

AF4

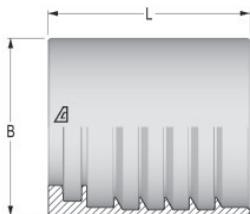

Part Number	Dash Size	Hose ID Size		B OD (mm)	L Length (mm)	Weight (lbs/each)
		(in)	(mm)			
AF4-06	06	3/8	9.5	30	28.0	0.11
AF4-08	08	1/2	12.7	34	33.9	0.16
AF4-10	10	5/8	15.9	38	36.6	0.20
AF4-12	12	3/4	19.0	42	39.5	0.28
AF4-16	16	1	25.4	50	45.4	0.51
AF4-20	20	1 1/4	31.8	62	50.1	0.55
AF4-24	24	1 1/2	38.1	68	59.0	0.71

Because we continually examine ways to improve our products, we reserve the right to alter specifications or discontinue products without prior notice.